

High-arm Speed Gate

PW_TD7823-1/2

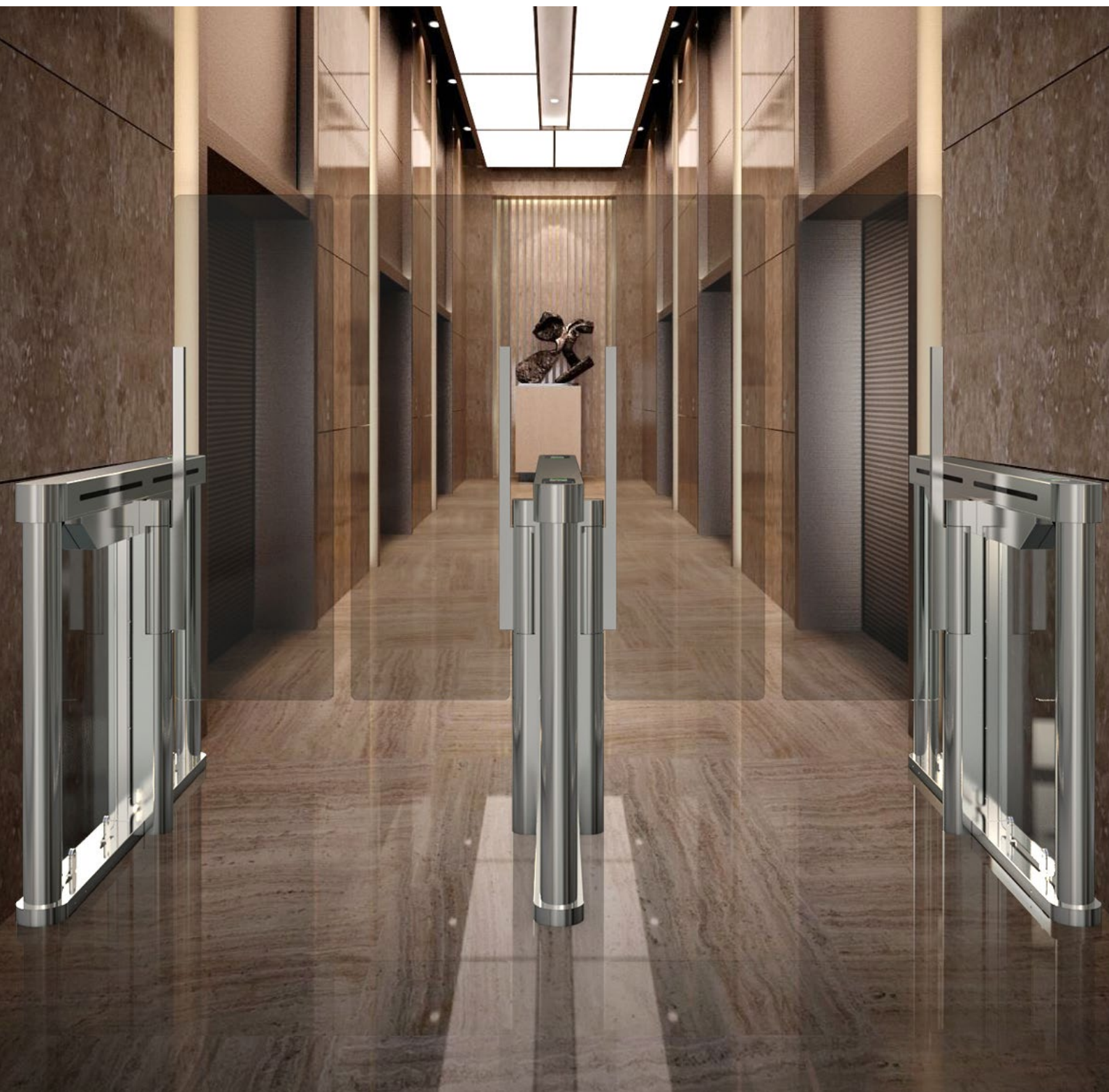

● SPECIFICATIONS

Structure Parameter

Material: SUS304 brushed stainless steel (Top cover 2.0mm, whole body 1.5mm)

Arm material: Tempered Glass/Acrylic

Size: L1600×W120×H1030mm

Arm height: 900–1800mm

Technical Parameter

Passage Width: Standard 550mm, max 1100mm

Passing Speed: 35–40 personal/min

Opening Speed: 1–2s

Working Temperature: -25°C–+70°C

Mean Cycles Between Failure: 8 million times

IP Rating: IP42

Passing Direction: Single directional / Bi-directional

Technical Parameter

Voltage: AC110V/AC220V±10% 50–60Hz

Operating Power: Single Core 180w, dual core 220w

Driving Motor: Servo motor

Method of position: Use the encoder to make sure the swing gate positioning

Communication Interface: RS485, TCP/IP interface

Number of Sensor: 6 groups(can be extended to 8 groups)

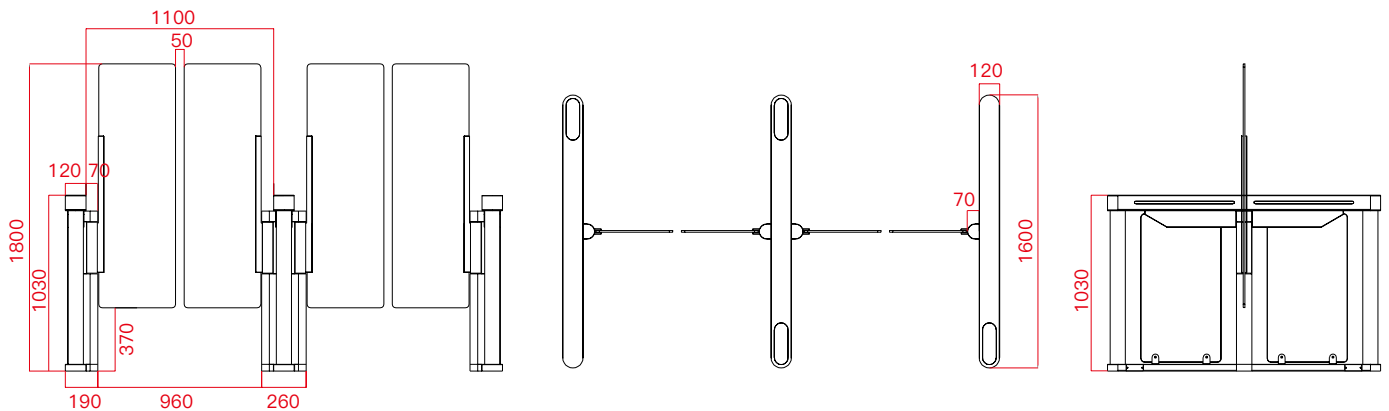

● STRUCTURES

● Multiple protection function

Anti-scratch: Infrared anti-pinch + mechanical anti-pinch + current detection anti-pinch; Triple anti-pinch technology to avoid the phenomenon of pinching people and objects.

Anti-trailing: Infrared detection judgment, personnel trailing alarm prompt

Anti-collision: Force to open, the swing arm will automatically locked at 5 degrees, and the delay is automatically reset to ensure personal safety and the swing arm won't be damaged.



● High-quality material

Using high-precision SUS 304 stainless steel thick plate material

corrosion resistance, high temperature resistance, oxidation resistance, durable

Whole body anti-fingerprint

Housing color can be customized

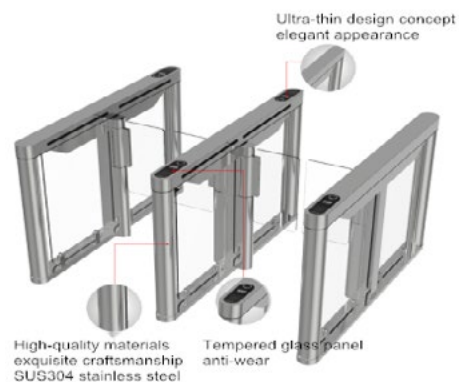

● Tempered Glass

8mm thickness tempered glass

Explosion proof, protecting passengers' safety

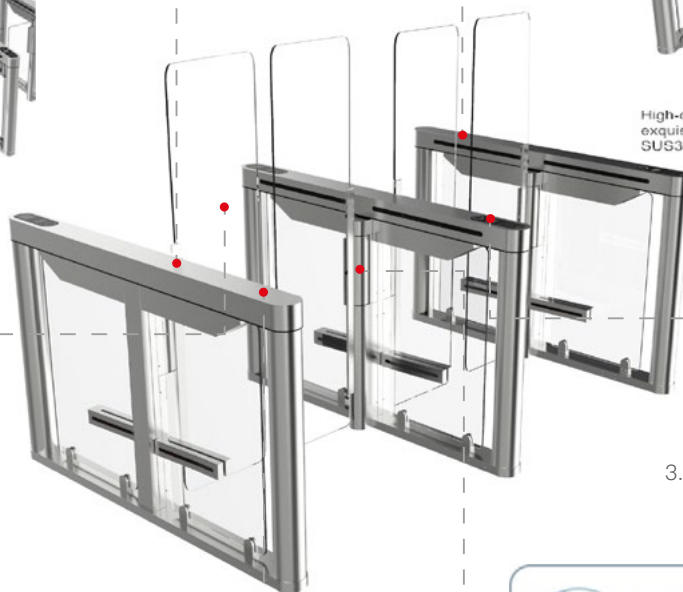

● Verify Access Mode

1. Swipe Card: Support IC/ID card
2. Fingerprint Recognition
3. QR Code: Mobile/Paper QR code
4. Facial Recognition



● Integrate Multiple Systems

Connected with the smart card system, access control system, consumer system, ticketing system, visitor system, static tester, etc.

● Servo Motor

Using Servo Motor, Highly stable and efficient

1024 signal detection points are located accurately

120W, 17NM motor to support high arm, with MBCF 8 million times



SECURITY FEATURES

1.Clipping

Triple anticlip technology to avoid pinching people and objects: Infrared anticlip + mechanical anticlip + current detection anticlip;

2.Tailgating

Multiple sets of infrared beams monitor the passage of people to prevent trailing;

3.Rushing

When rushing on the arm, it will automatically lock. According to the impact of the external force, the arm can be locked after a certain buffer angle, and it will return to its original position within a certain period of time. The arm is automatically locked at 5 degrees and automatically reset after a delay;

4.Wrong direction and intrusion detection

Precise calculation; infrared beam monitoring; reverse passing; sound alarming.

SAFETY FEATURES

- Accurate encoder positioning
- Emitter/receiver infrared sensors technology
- Logic voltage DC24V
- Emergency mode for Fire Alarm
- Manual push opening on power off
- Anti-panic push opening in operation
- Wide passage lane for wheel chair or easier access

DIFFERENT MODES OF SYSTEM INTEGRATION

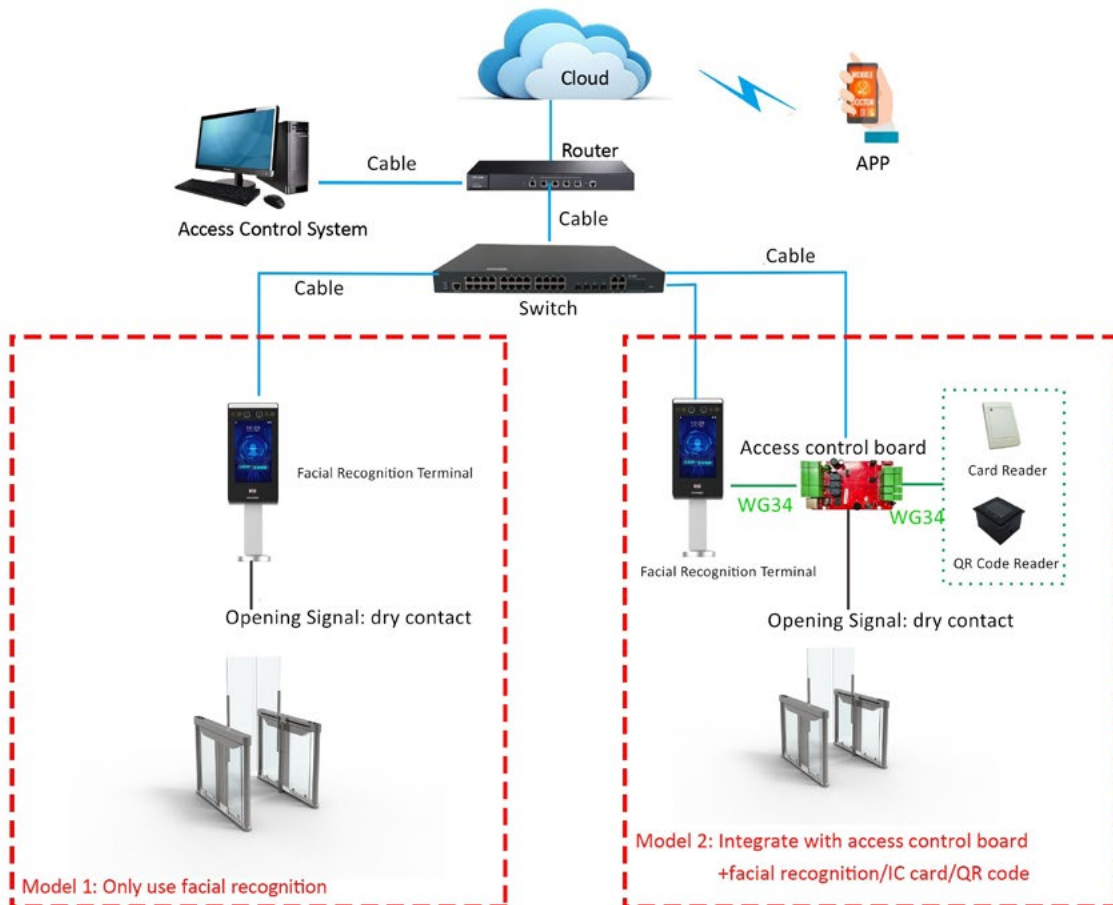

● APPLICATION



High-end community



Smart Building



Hotel



Shopping mall



School



Government Administration Building

Petawise Inc.